

45, Hillary Crescent, Walton-On-Thames, KT12 2DE

Energy Efficiency Rating	
Current	Potential
Very energy efficient - lower running costs	
(92 plus) A	84
(81-91) B	
(69-80) C	
(55-68) D	
(39-54) E	
(21-38) F	
(1-20) G	
Not energy efficient - higher running costs	
England & Wales	EU Directive 2002/91/EC

Environmental Impact (CO ₂) Rating	
Current	Potential
Very environmentally friendly - lower CO ₂ emissions	
(92 plus) A	
(81-91) B	
(69-80) C	
(55-68) D	
(39-54) E	
(21-38) F	
(1-20) G	
Not environmentally friendly - higher CO ₂ emissions	
England & Wales	EU Directive 2002/91/EC



£675,000 Freehold

Quietly located in the popular Hillary Crescent, Walton-On-Thames, this semi-detached house presents an excellent opportunity for families seeking a comfortable and spacious home. The property boasts two inviting reception rooms, perfect for both relaxation and entertaining guests. The skilfully extended layout features a large open-plan kitchen and dining room, complete with a central island, making it an ideal space for culinary enthusiasts and family gatherings. The sky lights and bi-fold doors bring in natural light in abundance and there is also the advantage of a separate utility room from the kitchen.

This delightful home comprises three well-proportioned bedrooms, providing ample space for family members or guests. The modern four-piece family bathroom is designed for convenience and comfort, ensuring that daily routines are a pleasure. Additionally, a contemporary downstairs cloakroom adds to the practicality of the living space.

Outside, the property is complemented by a large, mature rear garden, which includes a private patio area, perfect for enjoying al fresco dining or simply unwinding in a tranquil setting. The off-street parking on the private drive accommodates up to two vehicles, offering ease and security.

Situated close to popular schools, this residence is ideally located for families with children, ensuring that educational facilities are within easy reach. With its blend of modern amenities and a welcoming atmosphere, this property is a wonderful place to call home. Don't miss the chance to view this exceptional property in a sought-after location.

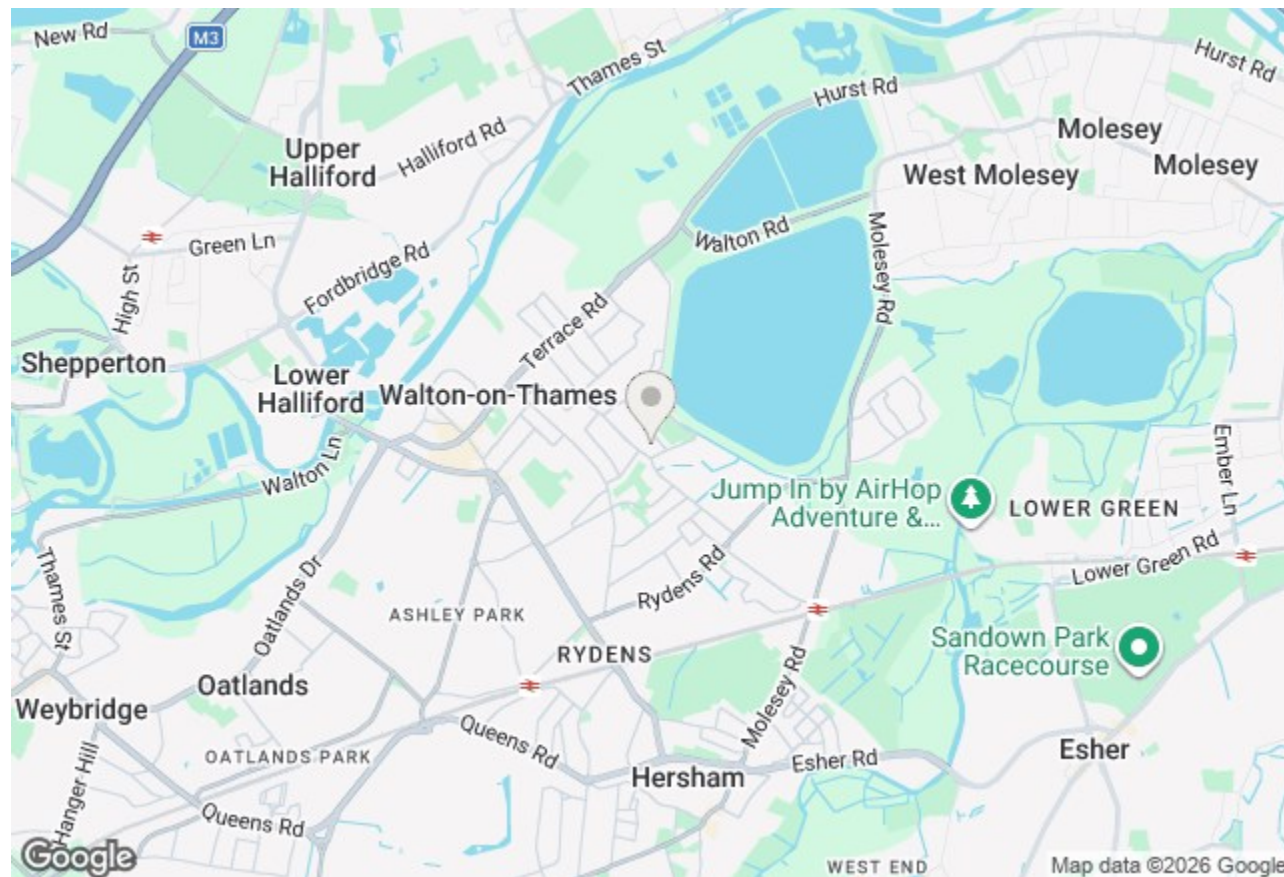

Hillary Crescent, Walton-On-Thames, KT12 2DE

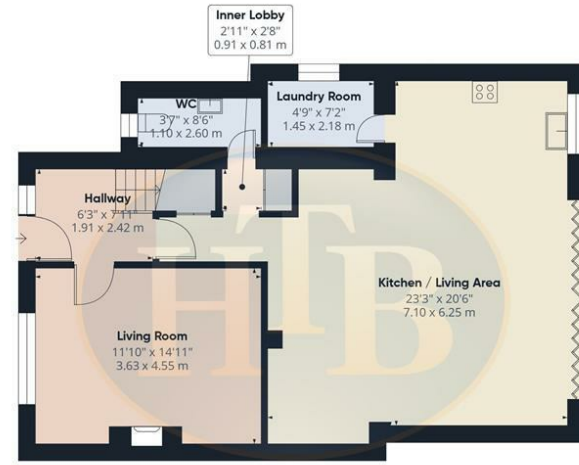

Floor 0



Floor 1



Approximate total area⁽¹⁾
 1152 ft²
 107.1 m²

(1) Excluding balconies and terraces

Calculations reference the RICS IPMS 3C standard. Measurements are approximate and not to scale. This floor plan is intended for illustration only.

GIRAFFE360



- THREE BEDROOMS
- LARGE REAR GARDEN WITH MATURE TREES AND SHRUBS
- MODERN DOWNSTAIRS CLOAKROOM
- SEPARATE LIVING ROOM
- MUST BE SEEN
- LARGE OPEN PLAN KITCHEN/DINING/FAMILY ROOM & SEPARATE UTILITY
- OFF STREET PARKING ON PRIVATE DRIVE
- MODERN FOUR PIECE FAMILY BATHROOM
- POPULAR CRESCENT ROAD CLOSE TO POPULAR SCHOOLS

